

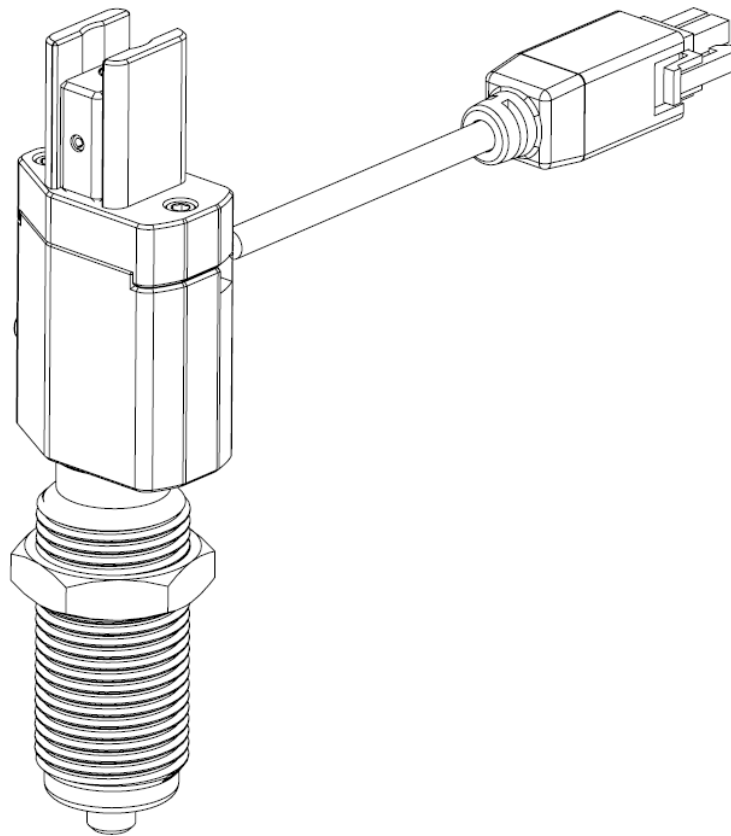

101-1038: Mark 7® Powder Check

Instruction Manual V 1.1



Read this manual completely. Understand all safety and operating instructions. Failure to comply with the warnings and instructions may result in serious injury, illness or death.

Package Content:

Please review package contents, if anything is incorrect or missing, please contact Mark 7 customer service immediately.

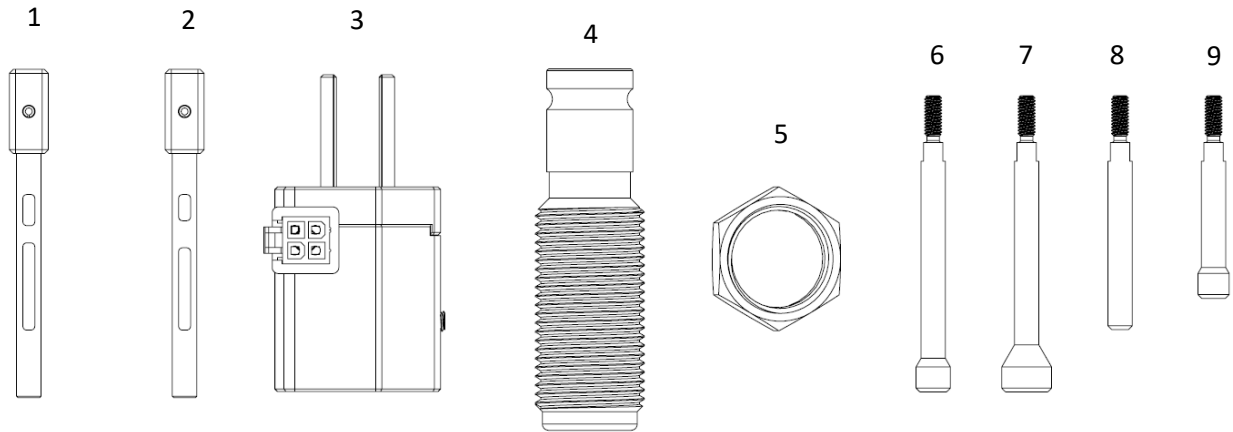

Item No.	Description	QTY
1	Powder Check Rod Assembly - Micro	1
2	Powder Check Rod Assembly - Macro	1
3	Powder Check Housing Assy	1
4	Powder Check Die	1
5	7/8"-14 Thread, Thin Hex Nut	1
6	Powder Probe Tip - Small Pistol	1
7	Powder Probe Tip - Large Pistol	1
8	Powder Probe Tip - Small Rifle	1
9	Powder Probe Tip - Large Rifle	1



Setup Procedures:

1. Select your **Powder Check Rod Assy** based on the following criteria:

-01 Rod: has a smaller filled middle section and should be used with new brass for a smaller margin of error. This rod is the more sensitive of the two. Using the -01 rod with mixed head stamp brass can cause false errors.

-02 Rod: has a larger filled middle section and should be used for mixed head stamp brass for a larger margin of error. This rod is less sensitive.

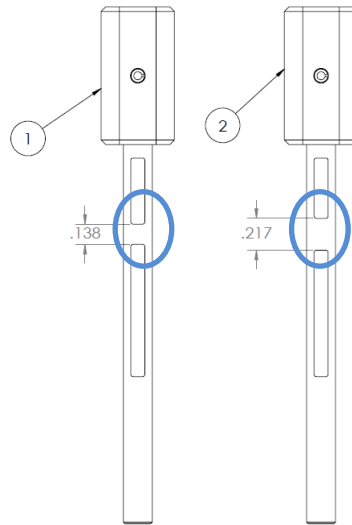

Figure 1: Powder Check™ Rod Assy.

2. Choose your **Powder Probe Tip** for your caliber size. First insert the rod assembly into the housing assembly. Thread on the probe onto the **Rod**. Use purple Loctite to ensure it does not get loose (see Figure 2 for the rod sizes for your caliber).

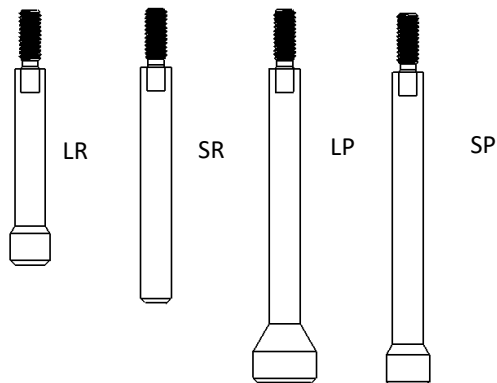

Figure 2: Powder Probe Tips.

3. Plug the sensor into port #4.

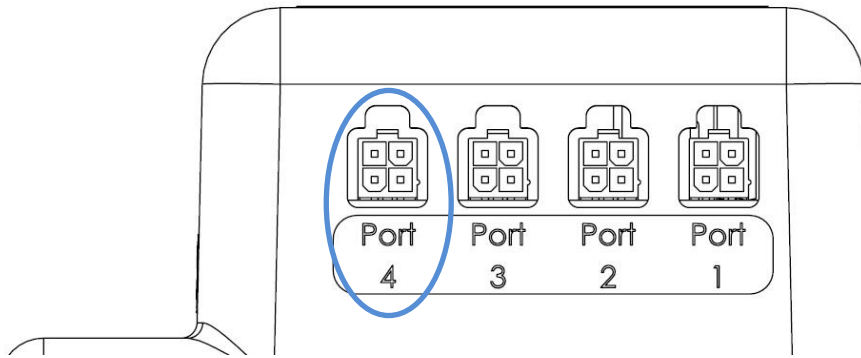

Figure 3: PowderSense® console port location.

4. Clear the Shell Plate, perform a fresh calibration.

****You must have the software version 02.07 or later installed.
Please visit <https://www.markvii-loading.com/knowledgebase>
for software update files and instructions ****

5. On the tablet tap the SENSORS tab and “enable” the Powdersense® sensor (will turn green).

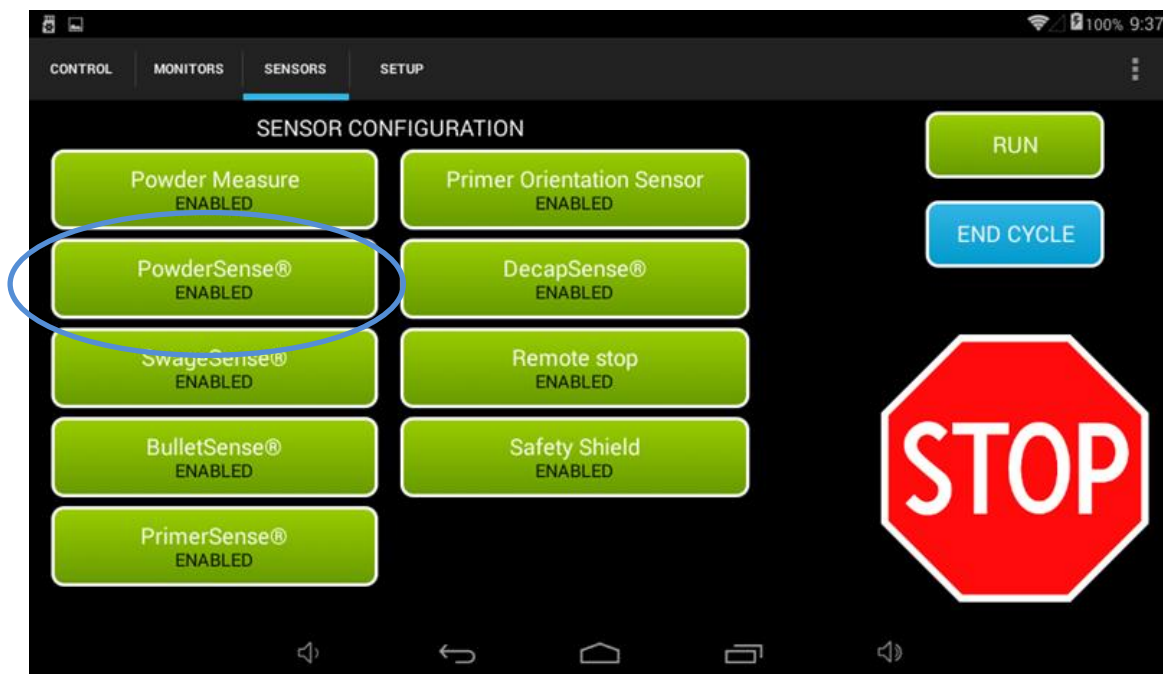
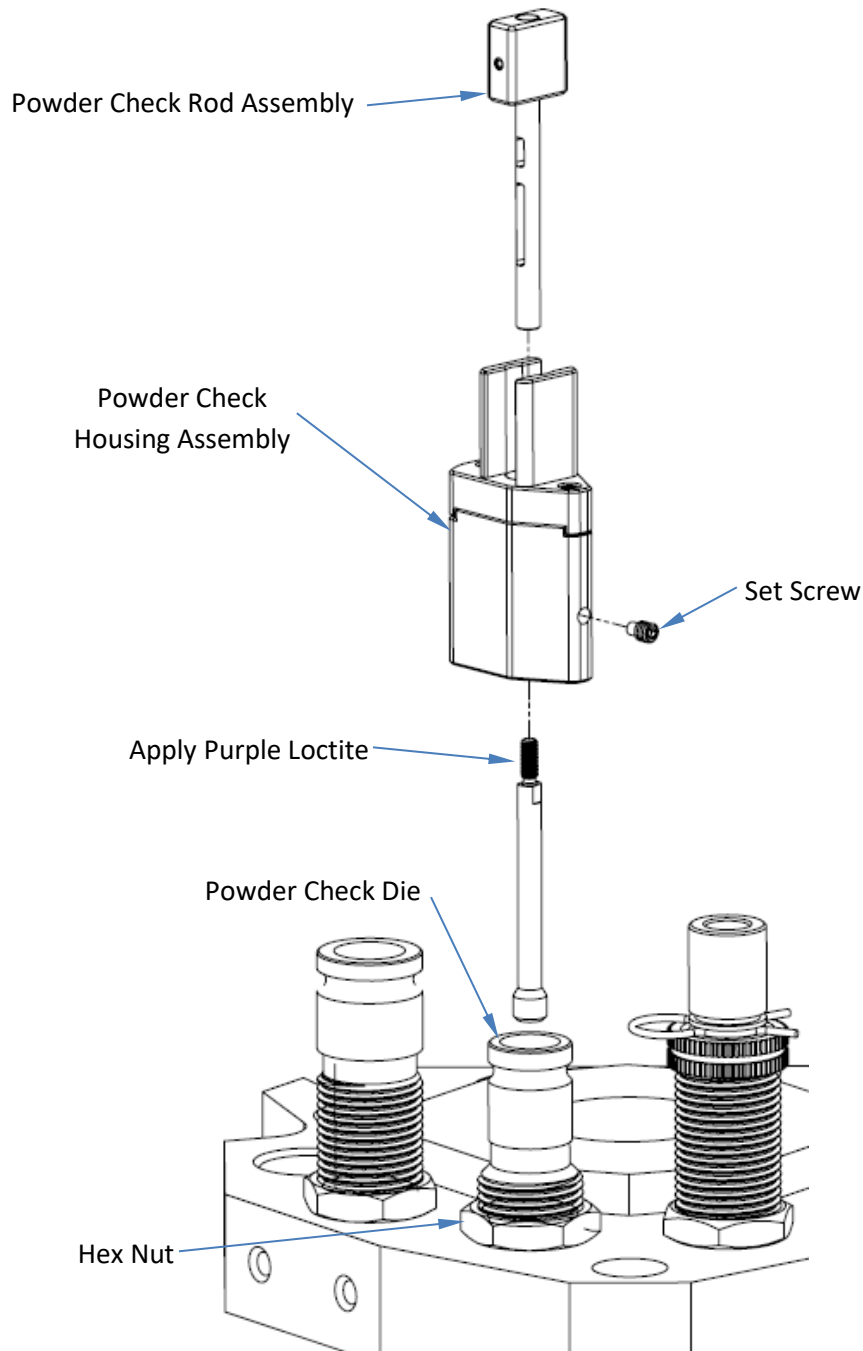

Figure 4: Enabling Powder Check®.



6. Thread down the bare **Powder Die** (with **Hex Nut**) into the Tool Head about halfway.
7. Place **Powder Check Housing Assy** onto the Die and thread in the set screw but do not tighten.



8. Place a Case into the Shell Plate with the desired charge and bring the Tool Head all the way down. Thread down powder die, until the top of the powder check rod assembly is flush with the top of the housing. See figure 5. Once correct, tighten set screw so assembly does not move. Tighten die nut.

9. Test the sensor with a case containing **no powder** and a **containing a double-charge** via single cycle to ensure you get an "incorrect powder level" error pop-up on the tablet.

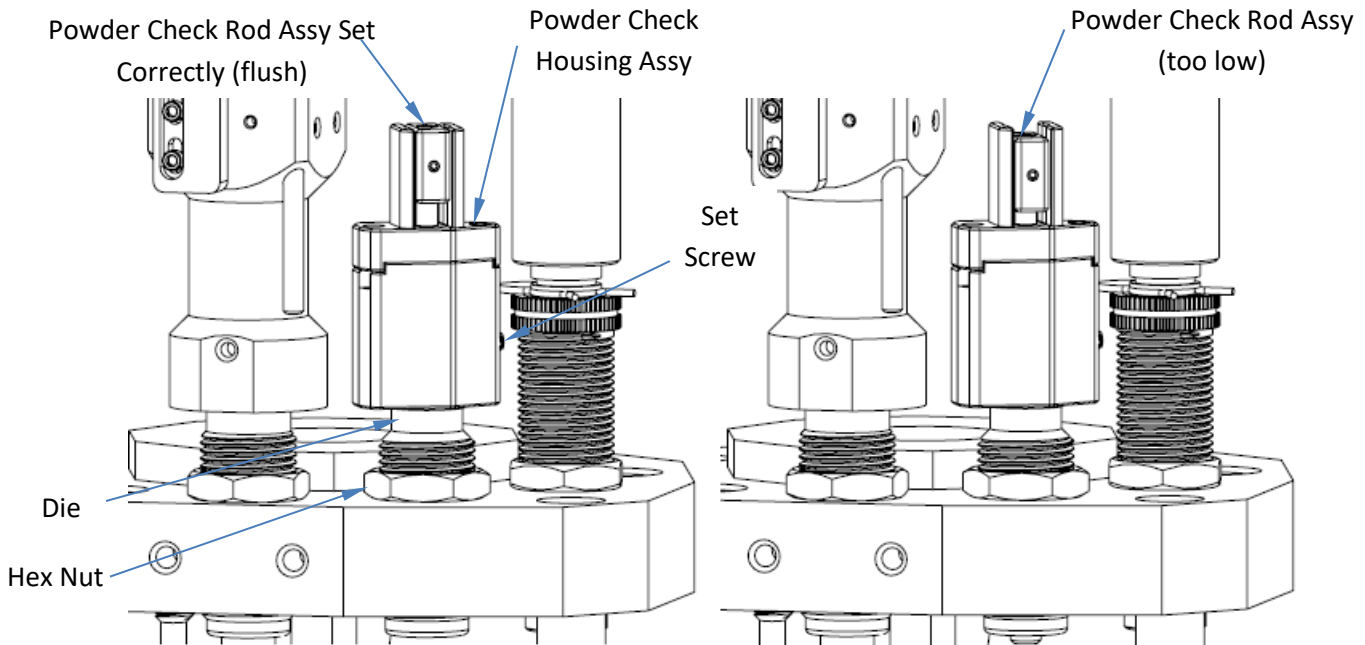

Figure 5: PowderCheck® Rod Assy alignment. Properly aligned (Left). Misaligned (Right).

Troubleshooting

Refer to the knowledge base section on our website under **SUPPORT** for troubleshooting articles relating to setup and operation.

<https://www.markvii-loading.com/knowledgebase>

Please contact us for technical support

Phone: 1-888-462-7577

Hours: 9:00am-4:30pm, ET, M-F